

Presentation to Georgian Bluffs Council regarding Safety of Grey Road 17B



Public Safety of Grey Road 17B

May 5th, 2021

Why we are here

Community Safety - Plain and Simple!

- We are pleased to present to Georgian Bluffs council on May 5th, 2021 to discuss our upcoming proposal to reduce speed limits of Grey Road 17B
 - As residents of Georgian Bluffs we hope and expect the support of our elected council members ahead of a forthcoming presentation we have with Grey County
 - We recognize that speed limits on County Roads in Grey Bruce are a Grey County matter, however it is important that as we endeavor to lower the speed limits on this road and we have the support of our Council!
 - This is about Community Safety - Plain and Simple!
- Representing the residents on Grey Road 17B and the surrounding area are the following
 - Russ Pierson, 107 West Street - Resident for 40 years
 - Kevin Lind, 104 West Street - Resident for ~7 years
 - As part of the lead up to this meeting, we have collected 28 signatures from the affected area, representing a 100% of the residents who reside on this County Road, all are supportive of lowering the speed limit of Grey Road 17B
- Our proposal to Grey County will be to lower the speed limit on Grey Road 17B to 50km/hour
- Our agenda today is to discuss with you our proposal and why it is important to the Community

Where are we talking?

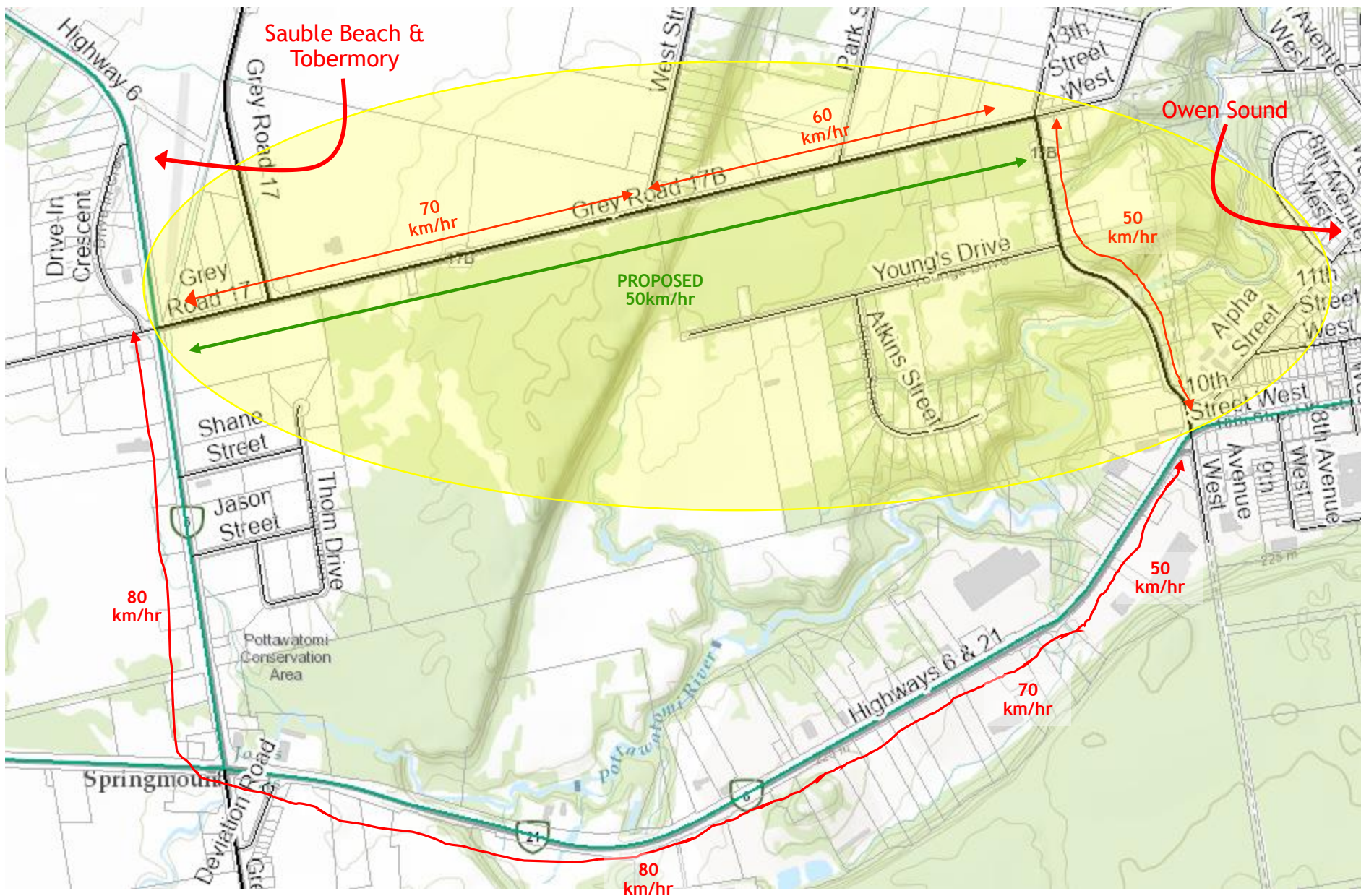

What difference does it make? THE FACTS



Every Road in the Area is 50 km/hr or Lower!!

- In 2020, the OPP set up traffic monitoring equipment on Grey Road 17B for the purposes of collecting volume and speed data
- According to the data compiled there are approximately 5,000 vehicles a day that use this stretch of Grey Road 17B
 - **ALMOST HALF OF THE VEHICLES ARE SPEEDING EVERY DAY!!**

- Almost every other road in this area is 40 to 50 km/hr
- Grey Road 17B should be no exception
 - Heavy trucks, blind spots, blind parking lots to the Conservation Area and the Bruce trail, a significant drop in elevation between West Street and Park Street, residences and an abundance of wildlife (Deer, Coyotes, Wild Turkeys etc.)

CURRENT TRAVEL TIMES

- Using Grey Road 17B
 - Distance: 3.1KM
 - Time: 4 min
- Using Highways 6 & 21
 - Distance: 3.8KM
 - Time: 4 min

PROPOSED TRAVEL TIMES

- Using Grey Road 17B @ 50 km/hr
 - Distance: 3.1KM
 - Time: 5 min
- Using Highways 6 & 21
 - Distance: 3.8KM
 - Time: 4 min

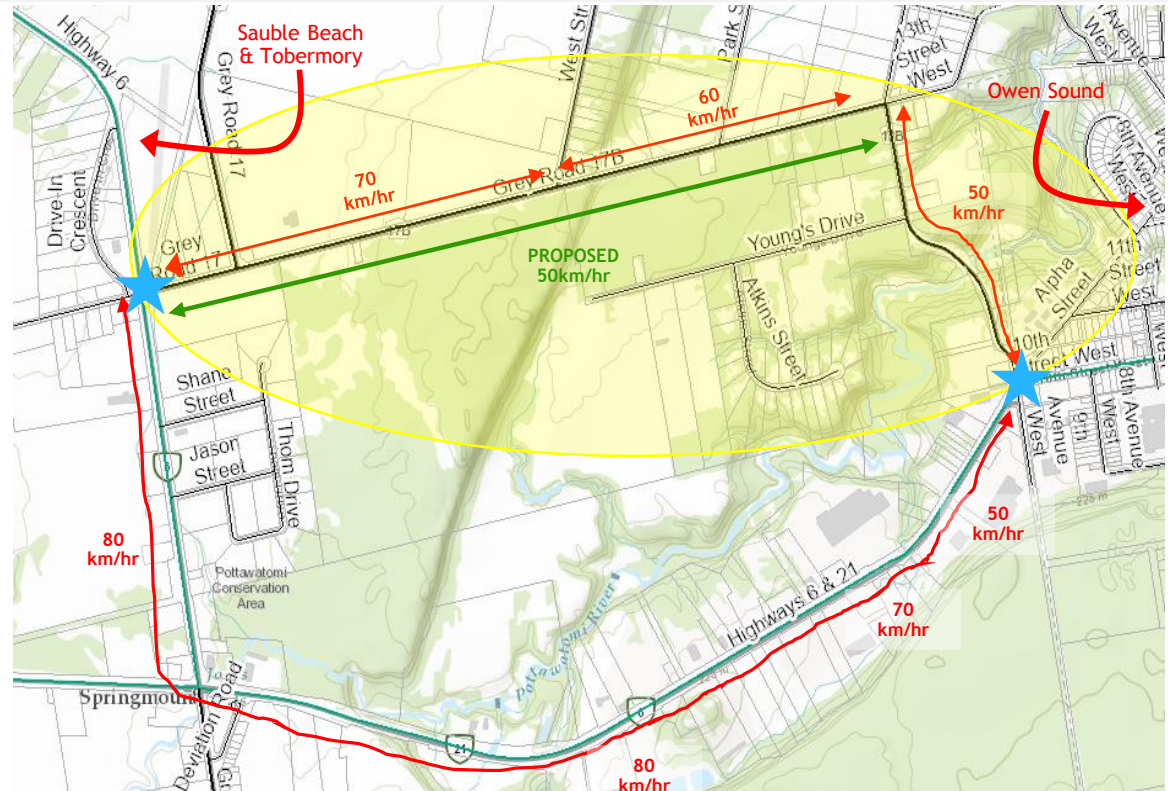

Lowering the Speed Limit will Encourage Motorists to use Highway 6 & 21, it's intended use!

Why the Speed Limit on Grey Road 17B should be Lowered!

Accident Prevention

Speeding Causes Accidents

- Plain and Simple - we have approximately 5,000 cars driving along Grey Road 17B and almost 50% of them are Speeding
- There have been at least 6 serious accidents on this stretch requiring EMS in the last 20 years

Pottawatami Conservation

- With people in the Community getting outside more during Covid we have seen increased number of hikers
- Blind parking lot along Grey Road 17B on the crest of a hill, often overcrowded, with cars parked along Grey Road 17B

Bruce Trail

- The Bruce Trail exits onto Grey Road 17B, at the crest of a large hill at a blind spot on the Escarpment, this is a risk to hikers and motorists, especially non-local!

West Street

- West Street abuts Grey Road 17B at the top of the escarpment, again blinded by the escarpment on the crest of a hill, often with little visibility or reaction time to merge with Grey 17B traffic due to the excessive speeding

Wildlife

- Due to the proximity of the conservation area, often Deer, Coyotes and flocks of Wild Turkey's cross the road without warning or visibility

Winter Weather

- Often cars can be found in the ditch in Nicols Gully and at the corner of West Street and Grey Road 17B
- Motorists are speeding and not giving themselves enough time to slow down to make basic turns

Non-Local Motorists

- Significant traffic volume is from Non-Local motorists using GPS (Google Maps, Waze) to drive up to Tobermory or Sauble Beach and use Grey Road 17B instead of Highway 6 & 21 because it's 53 seconds faster
 - Google Maps and Waze doesn't tell their user the Bruce Trail is ahead, to watch out for wildlife, or the blind spots to West Street or the Conservation parking lot...using Grey Road 17B helps their user get from point A to point B using algorithms to find the fastest way to get to their destination

Other Motorists

- With 2,400 motorists per day speeding on this roadway, the safety of other drivers that are also using this road is highly at risk. Why should these responsible drivers have to face the danger of others that use this road as a speedway

2021 Road Work Grey Road 17B

- Upcoming road work this summer will see Grey Road 17B lanes NARROWER to accommodate a bike lane

Incoming Bike Lane

- With a narrower road and increased usage from cyclists, the local running club, equestrians, dog walkers, children and Bruce Trail hikers, only makes common sense to reduce the speed!!

Lower the Speed Limit on Grey Road 17B for the betterment of the Community!

Why the Speed Limit on Grey Road 17B should be Lowered!

Support Local Businesses!

- By lowering the speed limit on Grey Road 17B, we will effectively divert traffic through commercial areas with Georgian Bluffs along Highway 6 & 21
- Our local businesses need all the support they can get and increasing the volume of traffic along Highway 6 & 21 will help drive people into stores, ordering curbside pick up, buying cars or just getting a coffee and a donut...every dollar counts and every opportunity Council has to make a impact on small businesses, while improving Community Safety should be an EASY DECISION!

Some of the Locally Owned Small Businesses and Franchises



Lower the Speed Limit on Grey Road 17B for the betterment of the Community!

Why the Speed Limit Should be Lowered!

In Line with Community Led Initiatives with Grey & Bruce County and its Municipalities

Community Safety & Well-Being Planning
THE MUNICIPALITIES OF BRUCE AND GREY

PRIORITY RISK AREA
3 Crime Prevention

This category includes animal cruelty, arson, break and enter, child abuse, drug trafficking, elder abuse, gang activity, homicide, human trafficking, intimate partner or domestic violence, physical assault, theft, sexual assault, and threats.

Although it is difficult to get a clear picture of police crime statistics for the Bruce and Grey region as a whole because of the differences in reporting between the OPP detachments and the 4 local Police Services, individual statistics are available for each OPP detachment and Police Service, and a review of this information will be of utmost importance as action planning in this area begins.

In addition to these statistics, below are some of the key **Addiction/Substance Use Indicators** and concerns highlighted in local data (4a). Action Tables will explore these in order to inform the creation of specific CSWBP Action Plans, as well as to monitor progress and improvements.

- Criminal Court cases show trends are increasing over time for most offences (2017 vs 2019-20 - 17% to 27% increase).
- Overall, assault injuries are comparable to Ontario rates except that the Bruce and Grey rate of Emergency Department visits due to assault is higher than the Ontario rate.

Community Perceptions

This category ranked third (#3) overall in the Bruce and Grey CSWBP Community Engagement Survey (overall, by Bruce County, 2nd by Grey County, and in top 3 by 12 out of 16 of the participating municipalities). It was ranked in the top 3 areas of importance by 44% of survey respondents (Bruce County 42%, Grey County 46%). When asked which areas were of particular concern in this category, break and enter, drug trafficking and theft were the top areas of concern followed by intimate partner or domestic violence and human trafficking. Several comments in the survey mentioned concern about the road safety issues, drug related property crimes and violence as well as the need for greater proactive/preventative policing (3).

Locally, the following organizations, programs and committees are already working to address concerns related to crime prevention across Bruce and Grey:

- Violence Prevention Grey Bruce
- Services provided by Victim Services Bruce Grey Perth
- RIDE program
- Bruce Peninsula Safe Communities Committee
- Southern Bruce County Safe Communities Committee

* This list is not all-inclusive.

Police Leaders

 Christopher R. Knoll Chief of Police Hanover Police Service	 Vince Wurfl Sergeant Newashlingmaring First Nation Police
 Paul Schambers Acting Inspector OPP - Grey Bruce	 Krista Miller Inspector OPP - South Bruce
 Mary Shannon Inspector OPP - Collingwood/Blue Mountain	 Craig Ambrose Chief of Police Owen Sound Police Service
 Kevin Zettai Acting Chief of Police Saugeen Shores Police Service	 Robert Martin Chief of Police West Grey Police Service

perence success in enhancing 4 Bruce Counties.

Section 4 | Bruce & Grey CSWBP

Grey Bruce Community Safety and Well-Being Plan



- By-law Number 2020-137
- Passed December 16, 2020 in Township of Georgian Bluffs

*“Given the percentage of residents who express satisfaction with these aspects of their lives, not surprisingly many also express satisfaction with their personal relationships and mental well-being, which are important contributors to overall well-being. **However, levels of satisfaction among people residing in Bruce and Grey Counties are comparatively lower for how well they feel the local government is responding to community needs...**”*

Priority Risk Area - Crime Prevention

Community Perceptions

When asked which areas were of particular concern in this category, break and enter, drug trafficking and theft were the top areas of concern followed by intimate partner or domestic violence and human trafficking. **Several comments in the survey mentioned concern about the road safety issues**, drug related property crimes and violence as well as the need for greater proactive/preventative policing.

Show the Community that you are a listening!

Why the Speed Limit Should be Lowered!

The Local Community WANTS the speed limit lowered!

- *Local petition to have Grey Road 17B speed limits lowered were supported by 100% of its Residents*
- *Some residents are considering moving to another area because of the Speed dangers of Grey Road 17B*
- *February 2019, local resident Susan Frook nearly lost her life while walking with her dog on Grey Road 17B*
- *Tragically her dog was struck by a car and succumbed to the injuries*
 - *Driver charged with careless driving*
 - *At Susan's request, two new signs were put up, only to replace old signs that were removed*
 - *Speed continues, but awareness for children, dog walkers, hikers, cyclists etc has not improved*
 - *The speed limit has to change and increased police presence is required to enforce it*
- *Local residents Pauline and Rick Farley write: "we have lived here since 2006 and we believe in total, there have been at least six serious accidents requiring EMS on the 1km stretch of road between Park St. and Somers St. in the past 20-years along Grey Road 17B "*
 - *This level of risk is unacceptable*
 - *The present speed limit of 60km/hr is too fast for drivers to safely stop for the many pedestrians and other users of the road*
 - *In addition to road safety, higher vehicle speeds create significantly more noise and create noise pollution and health problems. We operate a home business. Traffic noise has become a problem for us, affecting our sleep, work productivity and health*
 - *According to a research study in the United Kingdom, a 10km/hr reduction in vehicle speeds yields a 40% decrease in noise levels which would greatly reduce the noise pollution in our neighbourhood*

Lower the Speed Limit on Grey Road 17B for the betterment of the Community!

When the Speed Limit Should be Lowered!

Post Road Work Construction on Grey Road 17B - Summer 2021

The behavior of motorists using this road at highway speeds has to stop. Period.
The sensible solution is to simply lower the speed limit to 50 km/hr along Grey Road 17B

With the upcoming road work in spring/summer 2021 of Grey Road 17B we think this represents an opportune time for this proposal to take effect

Post Construction we are asking for your support and Grey County's to lower the speed limit to a safer level of 50km/hr

Thank you for your time and Consideration